

High-Performance Line Filter for Machinery/ Equipment/EV Application

Feature and Benefits

- A compact and light weight Filter design with a requiring minimum mounting space with simple and time saving installation with good accessibility for automatic and hand tools
- BL328H have solid,touch-safe Terminal block offering sufficient contacting cross section according to EN60204-1 installation standard
- BL328H provides enough performance to ensure EMC compliance of machinery in mixed (Class A) or even domestic (Class B) environments
- BL328H provides the attenuation performance needed to meet the requirement of various machine tools with up to 12 driving axes and ~10 to 20 m of motor each cable



Technical specifications

Maximum continuous operating voltage	3x520/300 VAC,50/60Hz
Operating Frequency	50/60Hz
Rated Currents	8 to 200A @50°C
High Potential Test voltage	L/N-GND 2800 VDC for 2 sec L-L 2250 VDC for 2 sec (BL358H) L-N 1300 VDC for 2 sec
Temperature range (operation and storage)	-25°C to +100°C (25/100/21)
Design corresponding to	UL 1283,IEC/EN60939
Flammability Corresponding to	UL 94V-2 better
Protection Category	IP 20
Overload Capability	1.5x Rated Current for 60 sec, once/hour

- New solid safety connector blocks available for the whole range
- Exceptional attenuation performance with low Leakage current
- Increase also the immunity if operated directly on mains input
- Most compact and slim filter design in fit with class C1 & C2 limit

Typical Application

- Three-phase variable speed motor drives, servo drives, inverters and converters
- Applications comprising energy conversion devices like machines or process automation equipment
- HVAC equipment, elevators, power supplies, UPS and further three-phase applications
- EV Charger & station ,Renewable energy Application

ELECTRICAL SCHEMATIC

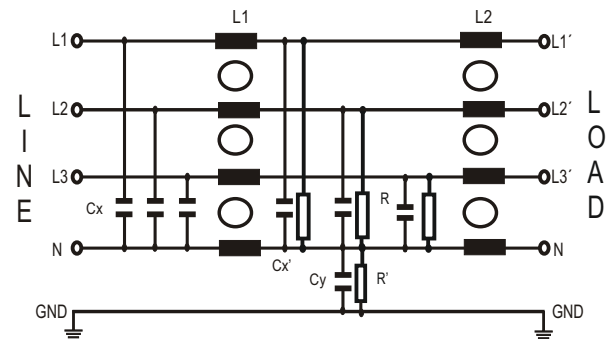

Temperature Derating Curve for EMC Filters Rated at 50°C Ambient and 100°C Maximum

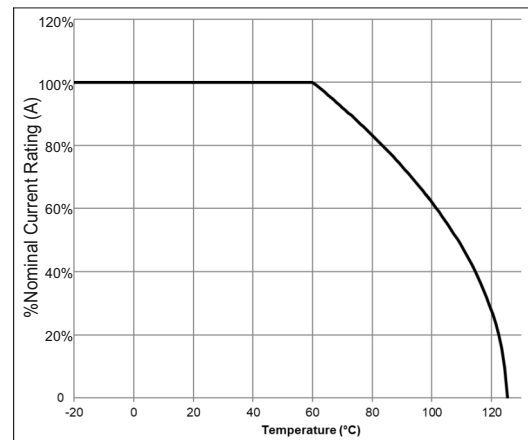

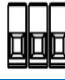

FILTER SELECTION TABLE

Filters**	Rated current @50°C (40°C)	Leakage current @520VAC/50Hz	Typical drive Power Rating	Power Loss @25°C/50Hz	Connetion type Input/Output	Weight
	A	mA	kW	W		Kg
BL328H-8-T	8(8.8)	10.7	4	2.7	T	0.8
BL328H-16-T	16(17.5)	10.7	8	6	T	0.8
BL328H-25-T	25(27)	10.7	13	11.6	T	1.3
BL328H-36-T	36(39)	10.7	18.5	14.8	T	1.6
BL328H-64-T	64(70)	10.7	33	18.4	T	2.7
BL328H-80-T	80(88)	10.7	41	18.9	T	4.1
BL328H-120-T	120(131)	10.7	62.4	28.5	T	5.9
BL328H-160-T	160(175)	10.7	83	30.7	T	7.9
BL328H-200-T	200(219)	10.7	100	46.8	T	8.5

** Standardized calculated leakage current acc. IEC60939 under normal operating conditions (BL328H at 520 VAC).

TYPICAL INSERTION LOSS, dB (50/50 Ohm)

Insertion Loss: Common mode - 
Differential mode- 

8 to 16 A types

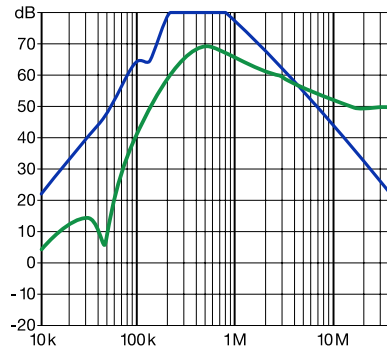

25 and 36 A types

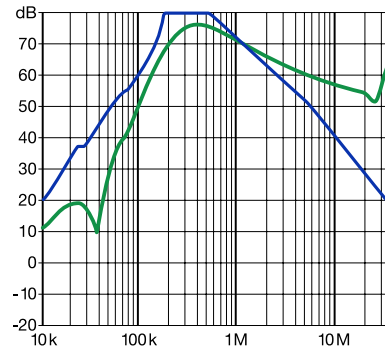

64 to 120 A types

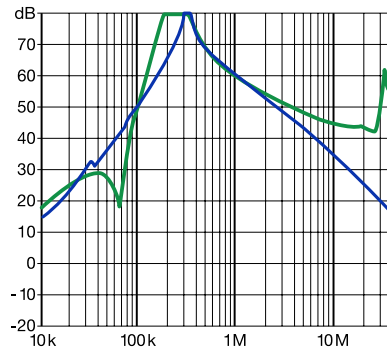

160 and 200 A types

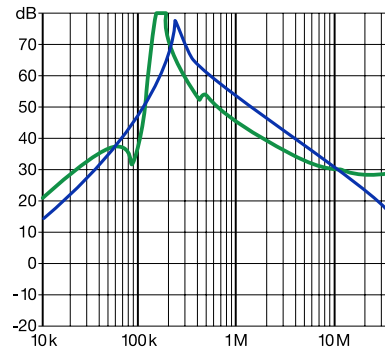

MECHANICAL DETAILS

8 & 16 Amp Terminal block

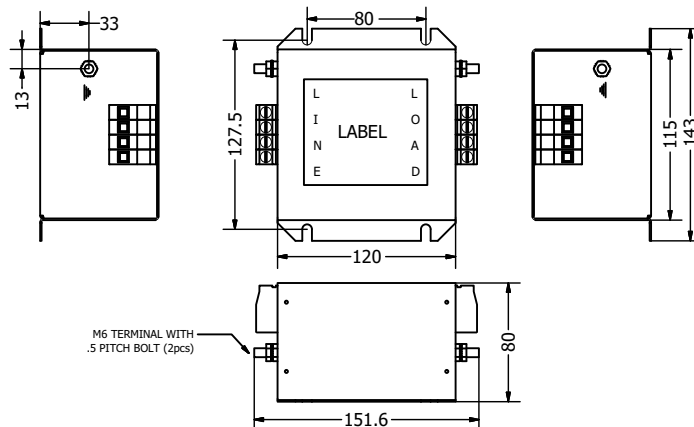

MECHANICAL DETAILS

25 & 36 Amp Terminal block

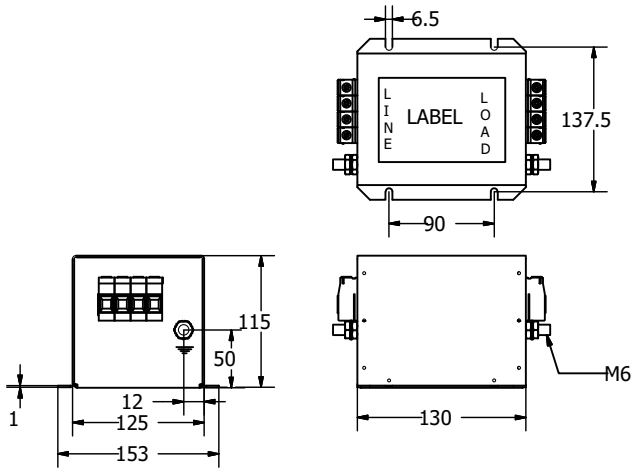

64 Amp Terminal block

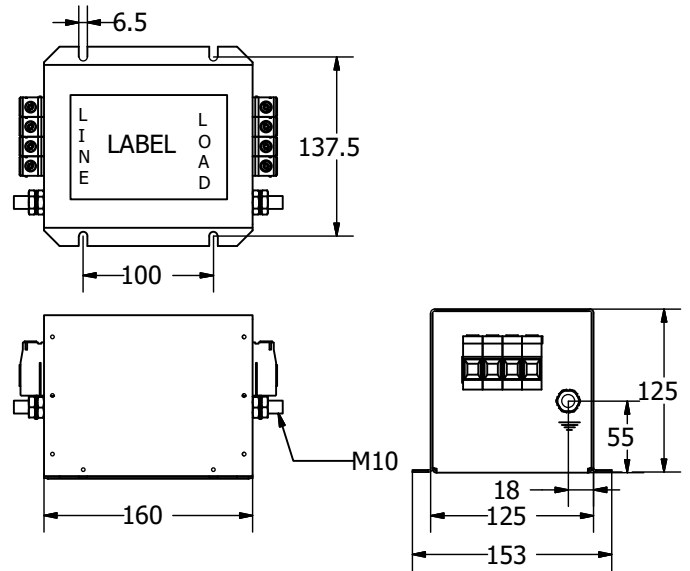

80 Amp Terminal block

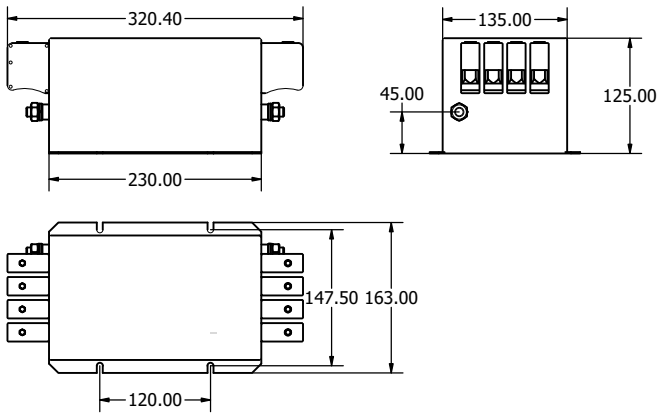

120 Amp Terminal block

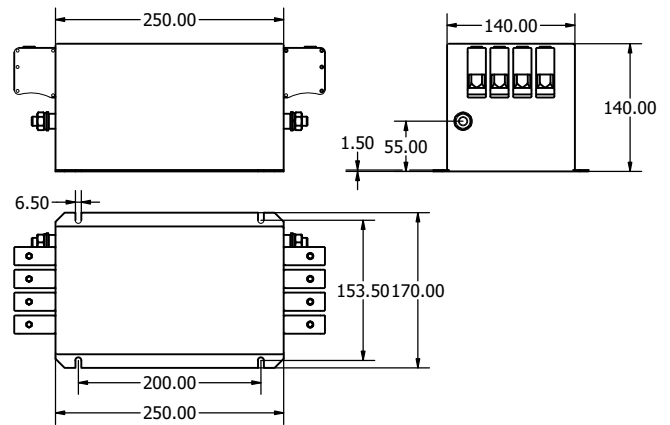

160 & 200 Amp Terminal block

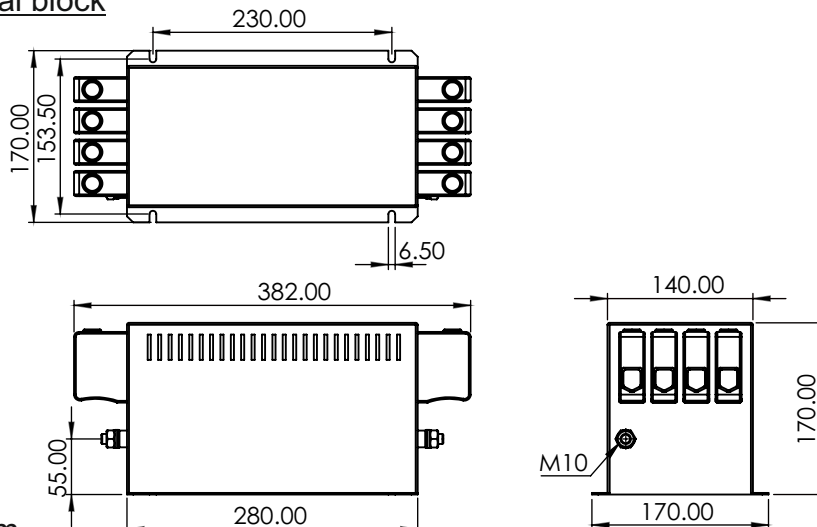

**All Dimension are in mm